

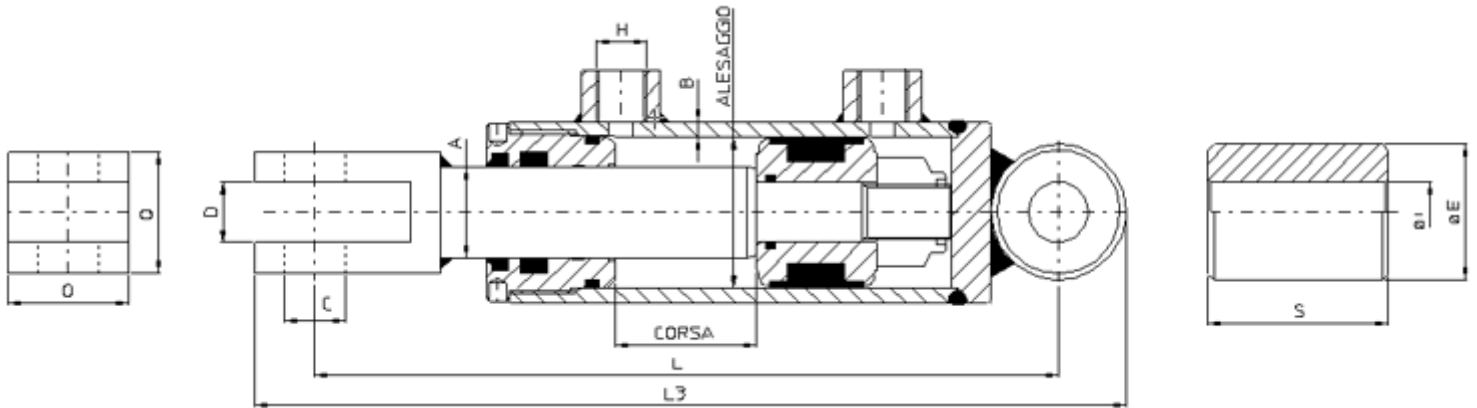

CILINDRO ESTANDARD DE DOBLE EFECTO CSFB

| | |
|---|-----------------------------------|
| CILINDRO STANDARD DOPPIO EFFETTO CSFB | PRESIONE DI ESERCIZIO MAX 220 bar |
| STANDARD DOUBLE ACTING CYLINDER CSFB | WORKING PRESSURE MAX 220 bar |
| VERIEN DOUBLE EFFET STANDARD CSFB | PRESION DE SERVICE MAX 220 bar |
| DOPPELTWIRKENDER STANDARDZYLINDER CSFB | BETRIEBSDRUCK MAX 220 bar |
| CILINDRO ESTANDARD DE DOBLE EFECTO CSFB | PRESION DE TRABAJO MAX 220 bar |



| CODIGO | DIÁMETRO INTERIOR | A | CARRERA | L3 | L | øi | øe | S | C | D | Q | B | H |
|--------------|-------------------|-------|---------|-----|-------|----|----|------|----|----|----|---|------|
| CSFB 3018100 | 30 | 18 | 100 | 318 | 284,5 | 16 | 35 | 16,2 | 50 | 16 | 35 | 5 | 1/4" |
| CSFB 3018150 | 30 | 18 | 150 | 368 | 334,5 | 16 | 35 | 16,2 | 50 | 16 | 35 | 5 | 1/4" |
| CSFB 3018200 | 30 | 18 | 200 | 418 | 384,5 | 16 | 35 | 16,2 | 50 | 16 | 35 | 5 | 1/4" |
| CSFB 3018250 | 30 | 18 | 250 | 468 | 434,5 | 16 | 35 | 16,2 | 50 | 16 | 35 | 5 | 1/4" |
| CSFB 3018300 | 30 | 18 | 300 | 518 | 484,5 | 16 | 35 | 16,2 | 50 | 16 | 35 | 5 | 1/4" |
| CSFB 3018350 | 30 | 18 | 350 | 568 | 534,5 | 16 | 35 | 16,2 | 50 | 16 | 35 | 5 | 1/4" |
| CSFB 3018400 | 30 | 18 | 400 | 618 | 584,5 | 16 | 35 | 16,2 | 50 | 16 | 35 | 5 | 1/4" |
| CSFB 40--100 | 40 | 20-25 | 100 | 342 | 299,5 | 20 | 45 | 20,2 | 60 | 20 | 40 | 5 | 1/4" |
| CSFB 40--150 | 40 | 20-25 | 150 | 392 | 349,5 | 20 | 45 | 20,2 | 60 | 20 | 40 | 5 | 1/4" |
| CSFB 40--200 | 40 | 20-25 | 200 | 442 | 399,5 | 20 | 45 | 20,2 | 60 | 20 | 40 | 5 | 1/4" |
| CSFB 40--250 | 40 | 20-25 | 250 | 492 | 449,5 | 20 | 45 | 20,2 | 60 | 20 | 40 | 5 | 1/4" |
| CSFB 40--300 | 40 | 20-25 | 300 | 542 | 499,5 | 20 | 45 | 20,2 | 60 | 20 | 40 | 5 | 1/4" |
| CSFB 40--350 | 40 | 20-25 | 350 | 592 | 549,5 | 20 | 45 | 20,2 | 60 | 20 | 40 | 5 | 1/4" |
| CSFB 40--400 | 40 | 20-25 | 400 | 642 | 599,5 | 20 | 45 | 20,2 | 60 | 20 | 40 | 5 | 1/4" |

| | | | | | | | | | | | | | |
|--------------|----|----------|-----|-----|-------|----|----|------|-----|----|----|-----|------|
| CSFB 40--450 | 40 | 20-25 | 450 | 692 | 649,5 | 20 | 45 | 20,2 | 60 | 20 | 40 | 5 | 1/4" |
| CSFB 40--500 | 40 | 20-25 | 500 | 742 | 699,5 | 20 | 45 | 20,2 | 60 | 20 | 40 | 5 | 1/4" |
| CSFB 40--600 | 40 | 20-25 | 600 | 842 | 799,5 | 20 | 45 | 20,2 | 60 | 20 | 40 | 5 | 1/4" |
| CSFB 50--100 | 50 | 25-30 | 100 | 349 | 306,5 | 20 | 45 | 20,2 | 70 | 20 | 40 | 5 | 3/8" |
| CSFB 50--150 | 50 | 25-30 | 150 | 399 | 356,5 | 20 | 45 | 20,2 | 70 | 20 | 40 | 5 | 3/8" |
| CSFB 50--200 | 50 | 25-30 | 200 | 449 | 406,5 | 20 | 45 | 20,2 | 70 | 20 | 40 | 5 | 3/8" |
| CSFB 50--250 | 50 | 25-30 | 250 | 499 | 456,5 | 20 | 45 | 20,2 | 70 | 20 | 40 | 5 | 3/8" |
| CSFB 50--300 | 50 | 25-30 | 300 | 549 | 506,5 | 20 | 45 | 20,2 | 70 | 20 | 40 | 5 | 3/8" |
| CSFB 50--350 | 50 | 25-30 | 350 | 599 | 556,5 | 20 | 45 | 20,2 | 70 | 20 | 40 | 5 | 3/8" |
| CSFB 50--400 | 50 | 25-30 | 400 | 649 | 606,5 | 20 | 45 | 20,2 | 70 | 20 | 40 | 5 | 3/8" |
| CSFB 50--500 | 50 | 25-30 | 500 | 749 | 706,5 | 20 | 45 | 20,2 | 70 | 20 | 40 | 5 | 3/8" |
| CSFB 50--600 | 50 | 25-30 | 600 | 849 | 806,5 | 20 | 45 | 20,2 | 70 | 20 | 40 | 5 | 3/8" |
| CSFB 60--100 | 60 | 30-35-40 | 100 | 387 | 342 | 25 | 50 | 25,2 | 80 | 25 | 50 | 5 | 3/8" |
| CSFB 60--150 | 60 | 30-35-40 | 150 | 437 | 392 | 25 | 50 | 25,2 | 80 | 25 | 50 | 5 | 3/8" |
| CSFB 60--200 | 60 | 30-35-40 | 200 | 487 | 442 | 25 | 50 | 25,2 | 80 | 25 | 50 | 5 | 3/8" |
| CSFB 60--250 | 60 | 30-35-40 | 250 | 537 | 492 | 25 | 50 | 25,2 | 80 | 25 | 50 | 5 | 3/8" |
| CSFB 60--300 | 60 | 30-35-40 | 300 | 587 | 542 | 25 | 50 | 25,2 | 80 | 25 | 50 | 5 | 3/8" |
| CSFB 60--350 | 60 | 30-35-40 | 350 | 637 | 592 | 25 | 50 | 25,2 | 80 | 25 | 50 | 5 | 3/8" |
| CSFB 60--400 | 60 | 30-35-40 | 400 | 687 | 642 | 25 | 50 | 25,2 | 80 | 25 | 50 | 5 | 3/8" |
| CSFB 60--500 | 60 | 30-35-40 | 500 | 787 | 742 | 25 | 50 | 25,2 | 80 | 25 | 50 | 5 | 3/8" |
| CSFB 60--600 | 60 | 30-35-40 | 600 | 887 | 842 | 25 | 50 | 25,2 | 80 | 25 | 50 | 5 | 3/8" |
| CSFB 70--100 | 70 | 30-35-40 | 100 | 387 | 342 | 25 | 50 | 25,2 | 90 | 25 | 50 | 5 | 3/8" |
| CSFB 70--150 | 70 | 30-35-40 | 150 | 437 | 392 | 25 | 50 | 25,2 | 90 | 25 | 50 | 5 | 3/8" |
| CSFB 70--200 | 70 | 30-35-40 | 200 | 487 | 442 | 25 | 50 | 25,2 | 90 | 25 | 50 | 5 | 3/8" |
| CSFB 70--250 | 70 | 30-35-40 | 250 | 537 | 492 | 25 | 50 | 25,2 | 90 | 25 | 50 | 5 | 3/8" |
| CSFB 70--300 | 70 | 30-35-40 | 300 | 587 | 542 | 25 | 50 | 25,2 | 90 | 25 | 50 | 5 | 3/8" |
| CSFB 70--350 | 70 | 30-35-40 | 350 | 637 | 592 | 25 | 50 | 25,2 | 90 | 25 | 50 | 5 | 3/8" |
| CSFB 70--400 | 70 | 30-35-40 | 400 | 687 | 642 | 25 | 50 | 25,2 | 90 | 25 | 50 | 5 | 3/8" |
| CSFB 70--500 | 70 | 30-35-40 | 500 | 787 | 742 | 25 | 50 | 25,2 | 90 | 25 | 50 | 5 | 3/8" |
| CSFB 70--600 | 70 | 30-35-40 | 600 | 887 | 842 | 25 | 50 | 25,2 | 90 | 25 | 50 | 5 | 3/8" |
| CSFB 80--100 | 80 | 40-45-50 | 100 | 433 | 378 | 30 | 60 | 30,2 | 100 | 30 | 60 | 7,5 | 1/2" |
| CSFB 80--150 | 80 | 40-45-50 | 150 | 483 | 428 | 30 | 60 | 30,2 | 100 | 30 | 60 | 7,5 | 1/2" |
| CSFB 80--200 | 80 | 40-45-50 | 200 | 533 | 478 | 30 | 60 | 30,2 | 100 | 30 | 60 | 7,5 | 1/2" |
| CSFB 80--250 | 80 | 40-45-50 | 250 | 583 | 528 | 30 | 60 | 30,2 | 100 | 30 | 60 | 7,5 | 1/2" |
| CSFB 80--300 | 80 | 40-45-50 | 300 | 633 | 578 | 30 | 60 | 30,2 | 100 | 30 | 60 | 7,5 | 1/2" |
| CSFB 80--350 | 80 | 40-45-50 | 350 | 683 | 628 | 30 | 60 | 30,2 | 100 | 30 | 60 | 7,5 | 1/2" |
| CSFB 80--400 | 80 | 40-45-50 | 400 | 733 | 678 | 30 | 60 | 30,2 | 100 | 30 | 60 | 7,5 | 1/2" |

| | | | | | | | | | | | | | |
|--------------|----|----------|-----|-----|-----|----|----|------|-----|----|----|-----|------|
| CSFB 80--500 | 80 | 40-45-50 | 500 | 833 | 778 | 30 | 60 | 30,2 | 100 | 30 | 60 | 7,5 | 1/2" |
| CSFB 80--600 | 80 | 40-45-50 | 600 | 933 | 878 | 30 | 60 | 30,2 | 100 | 30 | 60 | 7,5 | 1/2" |